

## MAV Pressure gauge connector

Female BSPB thread / EO 24° cone end

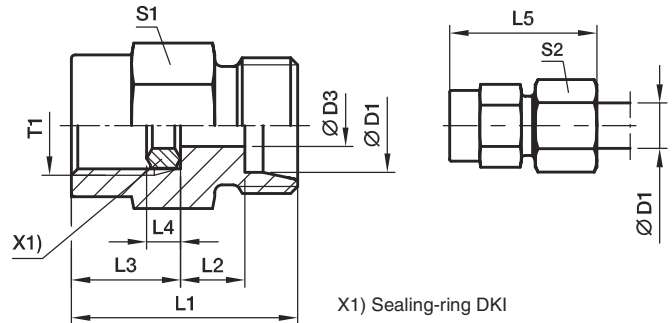

Series	D1 	T1	D3	L1	L2	L3	L4	L5	S1	S2	Weight g/1 piece	Order code*	PN (bar) <sup>1)</sup>		
													CF	71	MS
LL <sup>2)</sup>	04	G 1/4	2.5	27	8.5	14.5	4.5	33	19	10	33	<b>MAV04LLROMD</b>	100		
L <sup>3)</sup>	06	G 1/4	2.5	29	7.5	14.5	4.5	37	19	14	37	<b>MAV06LROMD</b>	315	315	200
	08	G 1/4	5.5	29	7.5	14.5	4.5	37	19	17	38	<b>MAV08LROMD</b>	315	315	200
	10	G 1/4	5.5	30	8.5	14.5	4.5	38	19	19	41	<b>MAV10LROMD</b>	315	315	200
	12	G 1/4	5.5	30	8.5	14.5	4.5	38	19	22	43	<b>MAV12LROMD</b>	315	315	200
S <sup>4)</sup>	06	G 1/2	3.5	38	11.0	20.0	5.0	46	27	17	86	<b>MAV06SROMD</b>	630	630	400
	08	G 1/2	3.5	38	11.0	20.0	5.0	46	27	19	86	<b>MAV08SROMD</b>	630	630	400
	10	G 1/2	7.5	38	10.5	20.0	5.0	47	27	22	88	<b>MAV10SROMD</b>	630	630	400
	12	G 1/2	7.5	38	10.5	20.0	5.0	47	27	24	93	<b>MAV12SROMD</b>	630	630	400

<sup>1)</sup> Pressure shown = item deliverable

<sup>2)</sup> LL = very light series; <sup>3)</sup> L = light series; <sup>4)</sup> S = heavy series

$\frac{PN(\text{bar})}{10} = PN(\text{MPa})$

Delivery without nut and ring. Information on ordering complete fittings see page I7.

Order code suffixes		
Material	Suffix surface and material	Example
Steel, zinc plated, Cr(VI)-free	CF	MAV10SROMDCF
Stainless Steel	71	MAV10SROMD71
Brass	MS	MAV10SROMDMS

\*Please add the **suffixes** below according to the material/surface required.

## MAVE Pressure gauge swivel connector

Female BSPB thread / EO 24° DKO swivel

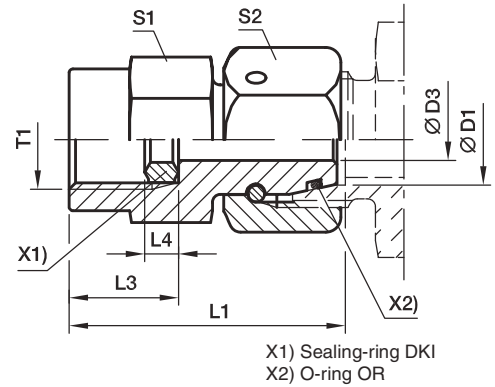

Series	D1 	T1	D3	L1	L3	L4	S1	S2	Weight g/1 piece	Order code*	PN (bar) <sup>1)</sup>	
											CF	71
L <sup>3)</sup>	06	G 1/4	2.5	35.5	14.5	4.5	19	14	46	<b>MAVE06LR</b>	315	315
	08	G 1/4	4.0	35.5	14.5	4.5	19	17	52	<b>MAVE08LR</b>	315	315
	10	G 1/4	5.5	36.0	14.5	4.5	19	19	59	<b>MAVE10LR</b>	315	315
	12	G 1/4	5.5	36.0	14.5	4.5	19	22	70	<b>MAVE12LR</b>	315	315
S <sup>4)</sup>	06	G 1/2	2.5	42.5	20.0	5.0	27	17	95	<b>MAVE06SR</b>	630	630
	06	G 1/4	2.5	35.5	14.5	4.5	19	17	52	<b>MAVE06SR1/4</b>	630	630
	08	G 1/2	4.0	43.0	20.0	5.0	27	19	100	<b>MAVE08SR</b>	630	630
	08	G 1/4	4.0	35.5	14.5	4.5	19	19	58	<b>MAVE08SR1/4</b>	630	630
	10	G 1/2	6.0	43.5	20.0	5.0	27	22	109	<b>MAVE10SR</b>	630	630
	10	G 1/4	7.0	39.0	14.5	4.5	19	22	67	<b>MAVE10SR1/4</b>	630	630
	12	G 1/2	7.0	45.0	20.0	5.0	27	24	125	<b>MAVE12SR</b>	630	630
	12	G 1/4	7.0	39.0	14.5	4.5	19	24	83	<b>MAVE12SR1/4</b>	630	630

<sup>1)</sup> Pressure shown = item deliverable

<sup>3)</sup> L = light series; <sup>4)</sup> S = heavy series

$$\frac{PN(\text{bar})}{10} = PN(\text{MPa})$$

Information on ordering alternative sealing materials see page 17.

Order code suffixes			
Material	Suffix surface and material	Example	Standard sealing material (no additional suffix needed)
Steel, zinc plated, Cr(VI)-free	CF	MAVE10SRCF	NBR
Stainless Steel	71	MAVE10SR71	VIT

\*Please add the **suffixes** below according to the material/surface required.