

## D Cutting ring · PSR Progressive stop ring

for EO 24° cone end

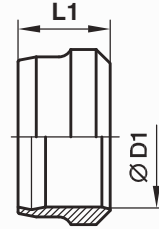
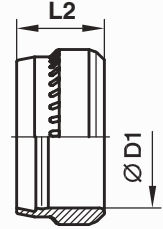

 Cutting ring:  
D

 Progressive stop ring:  
PSR

Series	D1	L1	Cutting ring D Order code						Progressive stop ring PSR Order code				Weight g/1 pc.
			Steel, zinc plated Cr(VI) free	PN (bar)	Stainless Steel	PN (bar)	Brass	PN (bar)	L2	Steel, zinc plated Cr(VI) free	PN (bar)		
LL	04	6.0	<b>D04LLX</b>	100	<b>D04LL71X</b>	100	<b>D04LLMSX</b>	63	—	—	—	0.3	
	06	7.0	<b>D06LLX</b>	100	<b>D06LL71X</b>	100	<b>D06LLMSX</b>	63	—	—	—	0.8	
	08	7.0	<b>D08LLX</b>	100	<b>D08LL71X</b>	100	<b>D08LLMSX</b>	63	—	—	—	1.0	
	10	7.0	<b>D10LLX</b>	100	<b>D10LL71X</b>	100	<b>D10LLMSX</b>	63	—	—	—	1.3	
	12	7.5	<b>D12LLX</b>	100	<b>D12LL71X</b>	100	<b>D12LLMSX</b>	63	—	—	—	1.6	
	L	06	9.5	—	—	—	—	<b>D06LMSX</b>	200	9.5	<b>PSR06LX</b>	500	1.7
08		9.0	—	—	—	—	<b>D08LMSX</b>	200	9.5	<b>PSR08LX</b>	500	2.2	
10		10.0	—	—	—	—	<b>D10LMSX</b>	200	10.0	<b>PSR10LX</b>	500	3.1	
12		10.0	—	—	—	—	<b>D12LMSX</b>	200	10.0	<b>PSR12LX</b>	400	3.5	
15		10.0	—	—	—	—	<b>D15LMSX</b>	200	10.0	<b>PSR15LX</b>	400	4.5	
18		10.0	—	—	—	—	<b>D18LMSX</b>	200	10.0	<b>PSR18LX</b>	400	5.5	
22		10.5	—	—	—	—	<b>D22LMSX</b>	100	10.5	<b>PSR22LX</b>	250	7.3	
28		10.5	—	—	—	—	<b>D28LMSX</b>	100	10.5	<b>PSR28LX</b>	250	9.4	
35		13.0	—	—	—	—	<b>D35LMSX</b>	100	13.0	<b>PSR35LX</b>	250	20.0	
42		13.5	—	—	—	—	<b>D42LMSX</b>	100	13.0	<b>PSR42LX</b>	250	23.0	
S		06	9.5	—	—	—	—	<b>D06LMSX</b>	400	9.5	<b>PSR06LX</b>	800	1.7
		08	9.0	—	—	—	—	<b>D08LMSX</b>	400	9.5	<b>PSR08LX</b>	800	3.2
	10	10.0	—	—	—	—	<b>D10LMSX</b>	400	10.0	<b>PSR10LX</b>	800	3.1	
	12	10.0	—	—	—	—	<b>D12LMSX</b>	400	10.0	<b>PSR12LX</b>	630	3.5	
	14	10.0	—	—	—	—	<b>D14SMSX</b>	400	10.0	<b>PSR14SX</b>	630	3.9	
	16	10.5	—	—	—	—	<b>D16SMSX</b>	250	10.0	<b>PSR16SX</b>	630	5.6	
	20	12.5	—	—	—	—	<b>D20SMSX</b>	250	13.0	<b>PSR20SX</b>	420	11.4	
	25	12.5	—	—	—	—	<b>D25SMSX</b>	250	13.0	<b>PSR25SX</b>	420	13.3	
	30	13.0	—	—	—	—	<b>D30SMSX</b>	250	13.0	<b>PSR30SX</b>	420	19.3	
	38	13.5	—	—	—	—	<b>D38SMSX</b>	200	13.0	<b>PSR38SX</b>	420	22.5	

$$\frac{\text{PN (bar)}}{10} = \text{PN (MPa)}$$

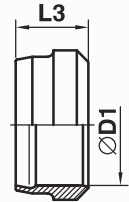
## DPR Progressive ring

for EO 24° cone end



Progressive ring: DPR

Series	D1 	L3	Progressive ring DPR Order code		PN (bar)	Weight g/1 piece
			Stainless Steel	Stainless Steel SPH		
L	06	9.0	DPR06L71X	DPR06LSPH71X	315	1.7
	08	9.0	DPR08L71X	DPR08LSPH71X	315	2.2
	10	9.5	DPR10L71X	DPR10LSPH71X	315	3.1
	12	9.8	DPR12L71X	DPR12LSPH71X	315	3.5
	15	9.5	DPR15L71X	DPR15LSPH71X	315	4.5
	18	9.5	DPR18L71X	DPR18LSPH71X	315	5.5
	22	10.5	DPR22L71X	DPR22LSPH71X	160	7.3
	28	11.0	DPR28L71X	DPR28LSPH71X	160	9.4
	35	13.5	DPR35L71X	DPR35LSPH71X	160	20.0
	42	13.5	DPR42L71X	DPR42LSPH71X	160	23.0
S	06	9.0	DPR06L71X	DPR06LSPH71X	630	1.7
	08	9.0	DPR08L71X	DPR08LSPH71X	630	3.2
	10	9.5	DPR10L71X	DPR10LSPH71X	630	3.1
	12	9.8	DPR12L71X	DPR12LSPH71X	630	3.5
	14	9.5	DPR14S71X	DPR14SSPH71X	630	3.9
	16	9.5	DPR16S71X	DPR16SSPH71X	400	5.6
	20	12.5	DPR20S71X	DPR20SSPH71X	400	11.4
	25	12.5	DPR25S71X	DPR25SSPH71X	400	13.3
	30	12.5	DPR30S71X	DPR30SSPH71X	400	19.3
	38	13.0	DPR38S71X	DPR38SSPH71X	315	22.5

$$\frac{\text{PN (bar)}}{10} = \text{PN (MPa)}$$